

XIV International Conference of Young Scholars **“Crucial Problems of International Relations** **through the Eyes of Young Scholars”**

General Instructions

Jan Masaryk Centre of International Studies
Central and East European International Studies Association (CEEISA)
Centre of European Studies and Konrad-Adenauer-Stiftung
Czech United Nations Association

27th May 2010

University of Economics, Prague, Czech Republic

Web: <http://icys.vse.cz/>

E-mail: icysprague@gmail.com

Coming to Prague

(For those who required accommodation)

Address of the dormitory:

Kolej Jarov I. E ([web pages](#))

Koněvova 196/355

130 00 Praha 3

Coming by plane

You will arrive at the *Airport Prague Ruzyně* – <http://www.prg.aero>.

Take a:

- 1) Taxi to the centre / dormitory: You should pay approximately 500-700 CZK, ie ca 19-26 EUR. Please, negotiate the price in advance.
- 2) Public transport to the centre / dormitory:
 - a) Take bus 179 to the stop *Větrník*, change to tram 1, and follow approximately 40 minutes to the stop *Strážní* (where the dormitory is located).
 - b) Take bus 119 to the stop *Dejvická*, change to subway line A to the station *Flora*, change to tram 16, and follow to the stop *Strážní*. (Both journeys take approximately 1 hour. The ticket costs 26 CZK, ie ca 1 EUR.)

Coming by train

You will arrive at the main train station *Praha Hlavní nádraží* (or at the train station *Praha Masarykovo nádraží* or *Praha Holešovice*).

Take a:

- 1) Taxi to the dormitory: Please, negotiate the price in advance.
- 2) Public transport from *Praha Hlavní nádraží* to the dormitory: Walk approximately 100 m to the tram stop *Hlavní nádraží*. Take tram 9 to the stop *Strážní* (where the dormitory is located). (The journey takes approximately 30 minutes. The ticket costs 26 CZK, ie ca 1 EUR.)

Coming by bus

You will arrive at the main bus station *Praha Florenc*.

Take a:

- 1) Taxi to the dormitory: Please, negotiate the price in advance.
- 2) Public transport to the dormitory: a) Take bus 207 to the stop *Ohrada*, change to tram 9, and follow to the stop *Strážní* (where the dormitory is located). b) Take bus 133 to the stop *Biskupcova*, change to tram 9, and follow to the stop *Strážní*. (Both journeys take approximately 20 minutes. The ticket costs 26 CZK, ie ca 1 EUR.)

Note that after you leave the tram at the stop *Strážní* you have to continue walking on foot for approximately 100 meters to get to the entrance of the dormitory.

Note that on the day of your arrival we cannot be present at the dormitory but we will inform the staff about your arrival (they will have a list of conference participants). You will check in at a little office located at the entrance of the dormitory (with a 24/7 service).

Coming to the University of Economic, Prague

Address of the university:

Vysoká škola ekonomická v Praze
Náměstí W. Churchilla 4
130 67 Praha 3

[Google Maps](#)

Dormitory – university

Take tram 9 from the stop *Strážní* to the stop *Husinecká*. Then follow on foot to Náměstí W. Churchilla, where the university is located (on your left). (Estimated time: 20 minutes.)

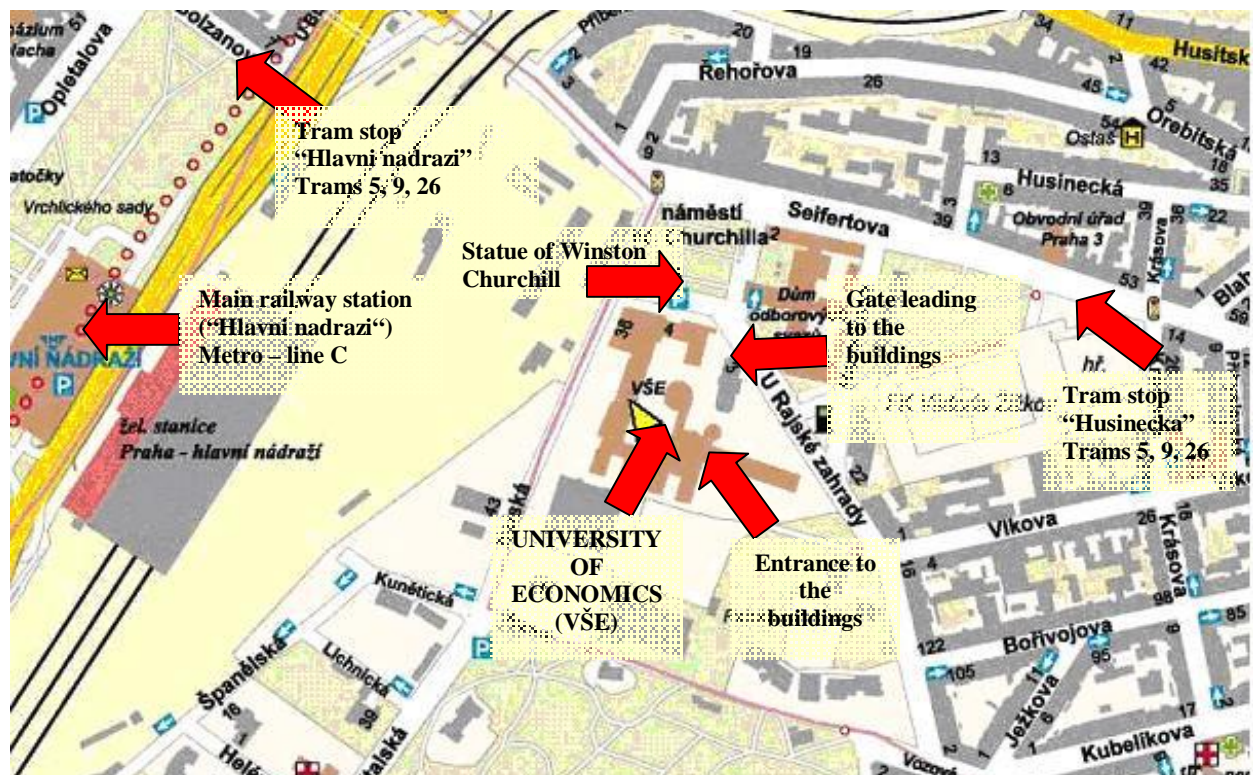

The conference will take place in the Rajská Building, the ground floor. We will inform you later on the exact location of the registration desk.

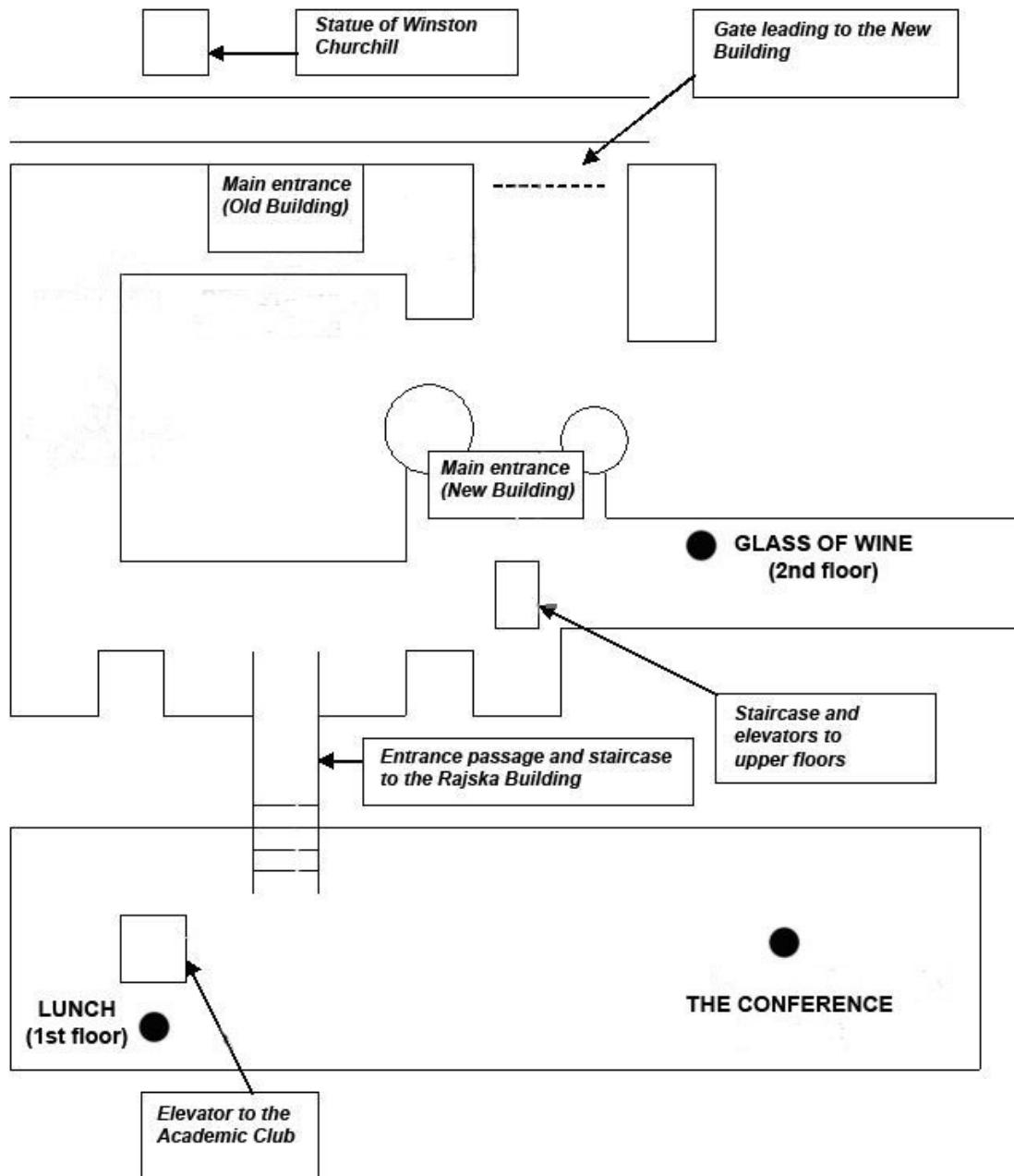

Aerial view



Rajská Building - main hall



Programme of the Conference

We will put the programme of the conference with all planned events (opening of the conference, schedule of the panels, lunch, glass of wine, etc.) on the web page of the Conference in mid-May 2010 at latest. Until then, check the preliminary programme http://icys.vse.cz/?page_id=133.

Presentations

Presentations are organised in panels; a panel is usually 90 mins long, and contains 4-5 participants on average. The presentation should not be longer than 15 mins; it is followed by a short debate not longer than 10 mins. For presentation purposes you may use a whiteboard/blackboard, an overhead projector, or equipment for PowerPoint presentation (bring your presentation on a CD or a USB flash disc). Those interested in publishing the paper should send it only after the conference (you will be provided with more information later).

Food

Please, note that food will be provided only on 27 May 2010. You can have a little breakfast directly in the conference rooms in the morning. Lunch will be provided in the university canteen (the Rajská Building, the 1st floor). There will be no dinner, however, we will invite you for a glass of wine and a refreshment in the evening. You will be provided with more information during the conference day.

(For those who will stay at the dormitory: There are also some grocery shops in and near the dormitory, open until late evening hours.)

Date of publication: 19th May 2010